

• The Pulley belt 14 should have no visible slack (see fig.11) and should be parallel with the top edge of the Mini-Grinder arm 21 as shown in fig.13. If the large pulley 10 is sitting to low or to high you will need to add or take away washers 11 so that the large pulley 10 is level with the small pulley 9.

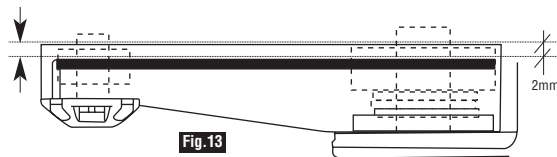

## 9. Secure belt tension cap

Once the belt 14 is correctly tensioned, lock the belt tensioning cap 6 into position by securing the four 1/2" self tapping screws 5 provided.(fig.14)

## 10. Fitting cover

Replace the front guard cover 15 with the three 3/8" self tapping screws 16 provided as shown in fig.15)

## 11. Fitting blade

Place the blade 17 onto small pulley 9 securely. There is a lip on the pulley that the blade should sit into, then place the blade clamping washer 19 on followed by the blade clamping bolt 18. Tighten the bolt by using the Allen key supplied in this kit and holding the blade 17 firmly (see fig.16).

## 12. Operation

Always wear correct safety clothing, including ear, eye and lung protection.

The Mini-Grinder should always be used with two hands, placing the left hand on the auxiliary handle and the right hand on the tool body as shown in fig.17.

Ensure the machine is running BEFORE contacting the material to be worked on.

To sand, polish or scrub hold the tool horizontally (fig.18).

Use this tool to cut or remove wood & plastics. The sanders are for sanding & cleaning wood, plastics, metal, paint and more...

## 13. Using the Mini-Sanders

Packed with the Mini-Grinder are a set of 4 assorted sanders. To replace the blade 17 with a sanding disc unscrew the clamping bolt 18 fully & remove the clamping washer 19 & blade 17. Insert the hexagonal bolt (supplied) into the sander keyway and wind into the small pulley 9. (see fig.19)

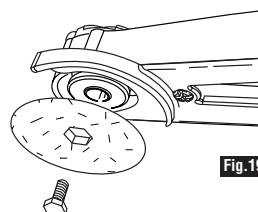
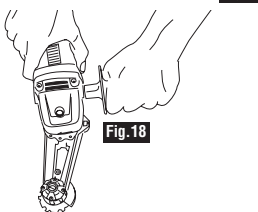
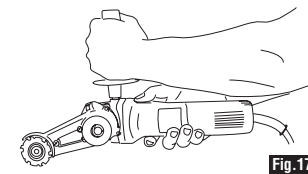
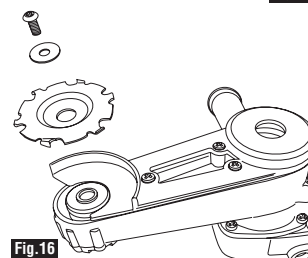
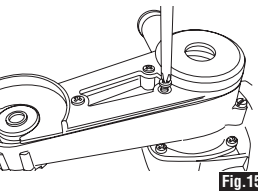
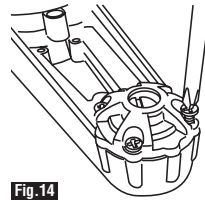

## FITTING INSTRUCTIONS MINI GRINDER EXTENSION WOODWORKING KIT

### STANDARD PARTS KEY

**This diagram is an overview only**

You will need:-

- 2.5mm Allen key (supplied)
- Slotted screwdriver
- Small Phillips head screwdriver
- Large Phillips head screwdriver
- Small adjustable spanner
- Small Ruler

1. Grinder collar section
2. Grinder Spindle
3. M6 Clamping Bolt
4. M6 Clamping Nut
5. 1/2" self tapping screws x 4
6. Belt Tensioning Cap
7. Bearing spindle assembly
8. Mini-Grinder Spindle
9. Small Pulley
10. Large Pulley
11. Spacer Washer\*
12. Pulley alignment ring
13. Lock nuts\*
14. Pulley belt
15. Front guard cover
16. 3/8" self tapping screws x 3
17. Mini-Woodcarver blade
18. Blade clamping bolt
19. Blade clamping washer
20. Adaptor plate screw housing
21. Mini-Grinder Attachment
22. Friction strip

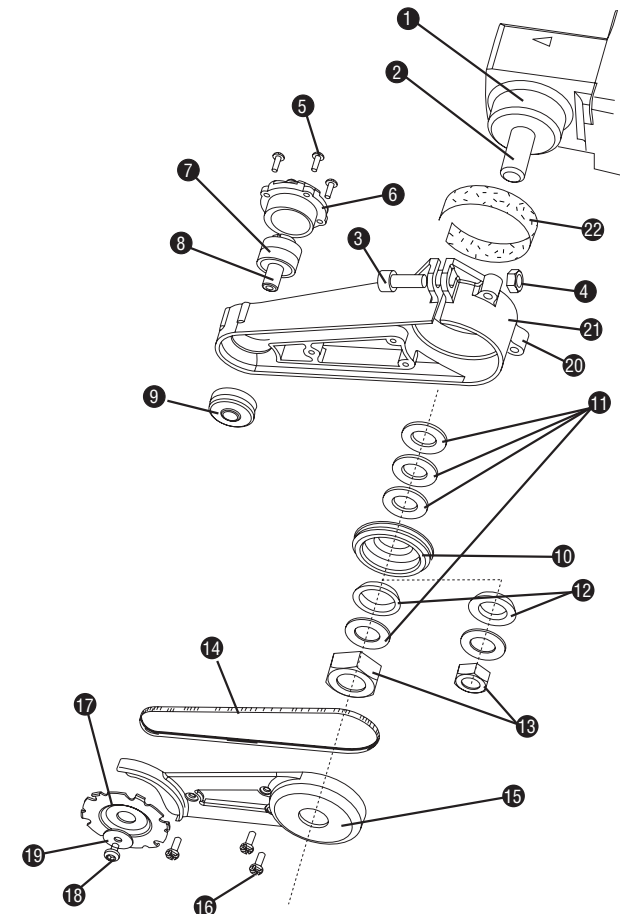

\*Additional parts for MIN200US provided for attachments supplied in the USA

#### Spacer Washers included in the Mini Grinder Kit:-

- 1 x 2mm Silver M10 spacer washer
- 1 x 1.6mm Yellow M10 spacer washer
- 1 x 1mm Red M10 spacer washer
- 1 x 2mm Orange (M14) spacer washer

- 1 x 5/8x21x2\* spacer washer
- 1 x 5/8x21x1.6\* spacer washer
- 1 x 5/8x21x1\* spacer washer
- 1 x M16 x 22, nylon step washer\*

**READ CAREFULLY AND SAVE**

# BASIC FITTING INSTRUCTIONS

Read the following instructions carefully to fit the Mini Grinder Attachment to your existing 4" (100mm) or 4.5" (115mm) angle grinder. Please be aware that the Mini Grinder Attachment may not fit all angle grinders. All numbers with a circle eg: ⑧ refer to the standard parts key on page 1.

1. If fitted, remove the back and front nuts from your angle grinder spindle ②. Some angle grinders may require the back nut at a later stage to fit the Mini Grinder attachment ②①. Remove the auxiliary grinder guard from the angle grinder. (See fig.1)

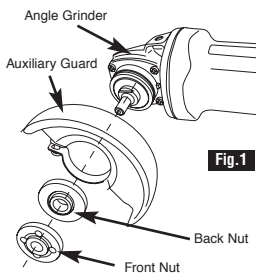

2. Check the following diagrams to see if the Mini Grinder extension ②① can be fitted to your angle grinder by using the grinder collar section (fig.2), or an Arbortech Adaptor Plate (MIN017) fig.3 & 4.

Some angle grinders may require a collar enlarging sleeve (MIN015) to securely fit the collar section to the grinder collar ①. (see fig.5)

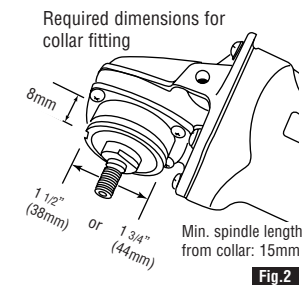

Fig.2

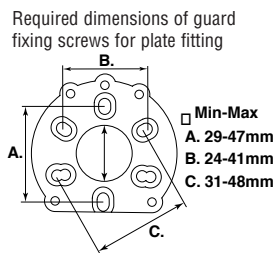

Fig.3

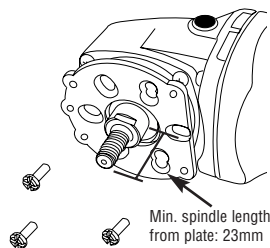

Fig.4

3. For collar fitting, continue via the instructions below.

For plate fitting, refer to the instructions provided in the MIN017 adaptor plate package.

DO NOT use the adaptor plate screw housings ②① to try to fit the Mini Grinder to the angle grinder.

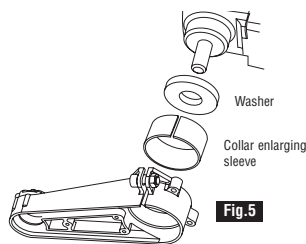

Fig.5

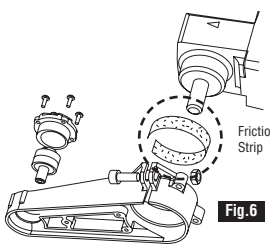

Fig.6

4. Some angle grinders may require a friction strip ②② (supplied) to secure the Mini-Grinder ②① to the angle grinder collar section ①. (see fig.6)

5. Remove the Mini-grinder front guard cover ①⑤.

6. Place the Mini-grinder extension arm ②① over the grinder collar ① and secure using the clamping nut ④ & clamping bolt ③.

**NOTE: Ensure that the Mini-Grinder arm is fitted flush against the grinder face. (See fig.7)**

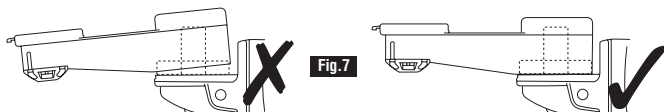

## 7. Large Pulley Assembly

• Fit the large pulley ⑩ with the cavity facing up (see fig.8) over the grinder spindle ②, using spacer washers supplied ①① underneath the large pulley to adjust it to the correct height (see fig.9). The large pulley needs to be at a similar height to the small pulley which is already fitted.

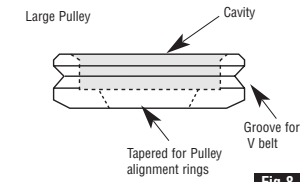

Fig.8

• Fit the pulley alignment ring ⑩② over the large pulley, so that the tapered edge fits in with the large pulley. Ensure the alignment ring ⑩② is seated well inside the large pulley ⑩.

• Then place another washer over the alignment ring followed by the correct size locking nut ⑩③ then tighten with an adjustable spanner while holding down the grinder spindle lock.

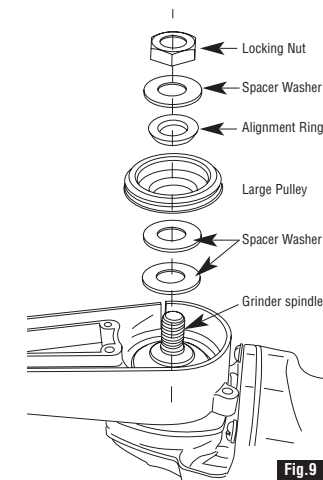

Fig.9

**NOTE:** The large pulley ⑩ can be fitted to the Grinder spindle ② with the cavity facing up or down (see fig.8). Depending on your grinder model, check which best suits the particular configuration of the spindle. If the large pulley ⑩ is fitted with cavity down, ensure to position the pulley alignment ring ⑩② on the Grinder spindle ② before fitting the large pulley ⑩.

**NOTE: If you have purchased the Mini Grinder in the USA, it will contain a 5/8" size pulley, which does not require the pulley alignment ring. If you require an M10 or M14 pulley & alignment ring, please contact Arbortech.**

## 8. Aligning the Pulley Belt correctly

• You may need to remove the blade ①⑦ with the key provided so the small pulley ⑨ is visible to check the alignment of the belt ①④.

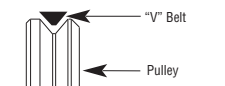

Fig.10

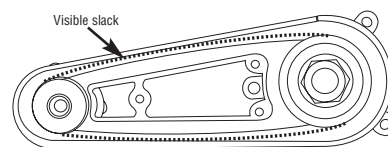
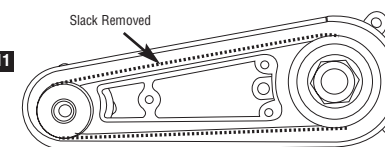

Fig.11



• To check that the large pulley ⑩ is at the correct height you will need to place the belt ①④ over both pulleys so that the V groove of the belt is sitting in the groove of both pulleys. (see fig.10)

• Tensioning the belt ①④ is now required by turning the pulley tensioning cap ⑥ (fig.12). Hold the tool in a way so that the belt is visible. As you turn the tensioning cap ⑥ you will notice that the belt slowly tensions as shown in fig.11.

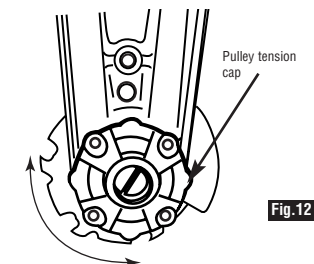

Fig.12

Continues on next page